

Brio Series

LED ALUMINUM PROFILE

Model No. BR-F-ALP052X

- Creates a homogenous light with uniform intensity
- The extrusion made from high quality aluminum.
- Suitable for strips width upto 12mm wide.
- The extrusion can be floor type
- Customized length upto 4 meters
- Anodized / Powder coated
- Excellent heat sink

Applications- walk area, gyms.



Beam angle: 40°

Weight: <0.87kg/m

Max power: <20w/m

Mounting: Floor

DIMENSIONS

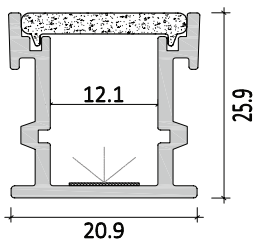

ACCESSORIES

END CAP



DIFFUSERS

Diffuser type		
	Opal Matt	Frosted
Model no.	BR-F-ALP052M	BR-F-ALP052F
Transmittance	32%	49%

INSTALLATION

